

BHN 601/BHN 601 01/BHN 611 01

Manual actuated block and vent/block and block

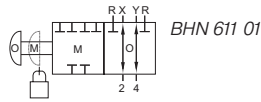
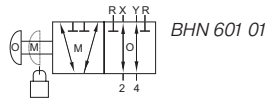
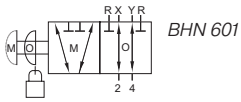

Intermediate valve for assemblage onto the actuator with 1/4" NAMUR-interface. Blocks signals from pilot-valve.

BHN 601 exhausts actuator when knob is pulled. Lockable in standard operation mode (O-position).

BHN 601 01 exhausts actuator when knob is pushed. Lockable in manual mode (M-position). Protection against unintended use with pin.

Typical application: to avoid injuries of maintenance personal when working on installed process equipment.

BHN 611 01 blocks actuator when knob is pushed. Lockable in manual mode (M-position). Protection against unintended use with pin.

Typical application: For process valves on tanks where maintenance people have to go into the tank.

If the valve is required with G 1/4" ports, plate GPN 1/4 can be added. For details please refer to page 2.11.13.

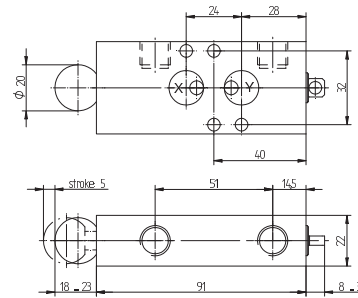

Delivery includes 1 pin, 2 screws, 2 O-rings.

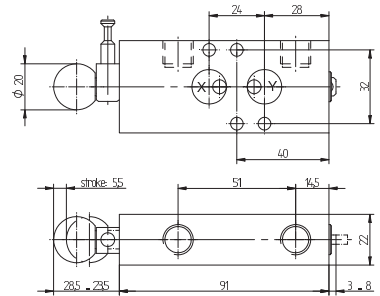

BHN 601



BHN 601 01/ BHN 611 01

Type	Function	lockable	Air flow	Operating press.	Actuation force	Weight
BHN 601	vents actuator	O-position	900 l/min	1 - 10 bar	18 N	0,23 kg 
BHN 601 01	vents actuator	M-position	900 l/min	1 - 10 bar	18 N	0,24 kg 
BHN 611 01	blocks actuator	M-position	900 l/min	1 - 10 bar	18 N	0,24 kg 