

# RB 5\_\_704 K1

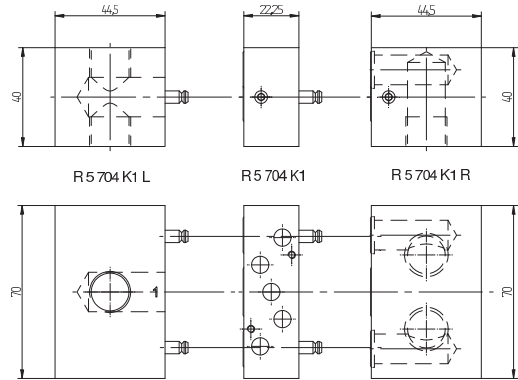

Bottom side



Parts of modular manifold RB 5\_\_704 K1

Modular manifold system with all ports on the bottom. Plates are designed for assemblage in control cabinets.

Common connection to port 1 (pressure), 3 (exhaust) and 5 (exhaust). The ports 2 and 4 of the individual valves are also located in the manifold plate. The system can be build up and taken apart by just operating two hexagon socket screws. Additional stations can be added at any position and any time.

The following valves can be assembled to the system  
**RB 5\_\_704 K1:**

- 5/2 single solenoid      MH 510 704      page 2.5.2.2.4
- 5/2 double solenoid    MH 520 704      page 2.5.2.2.7
- 5/3 solenoid            MH 53\_704      page 2.5.3.2.3

3/2-way functions by closing either port 2 or 4.

The system consists of:

- End-plate right            type R 5 704 K1 R
- End-plate left            type R 5 704 K1 L
- Individual position      type R 5 704 K1

Blanking plates are also available type BP 5 704.

Please note:  
 End-plates are not offering an individual valve-position.

The plates can also be ordered assembled by the manufacturer. In this case order **RB 5\_\_704 K1**. Please add two digits for the number of positions required.

In case the customer wants to have the FRL inside the box, the endplate left offers as second supply port that faces inside the box. One of the two has to be closed with a G 3/8" plug.

The individual plates are also available with individual valve isolation type R 5 704 K1 D1. In certain industries the user appreciates, if he can take away air pressure at any valve on the plate individually. Valves can easily be exchanged by closing the plug in port 1 without interruption of the air-supply of the other valves.

Wider elements for usage with wider coils (e.g. ATEX-approved versions) are available on request.

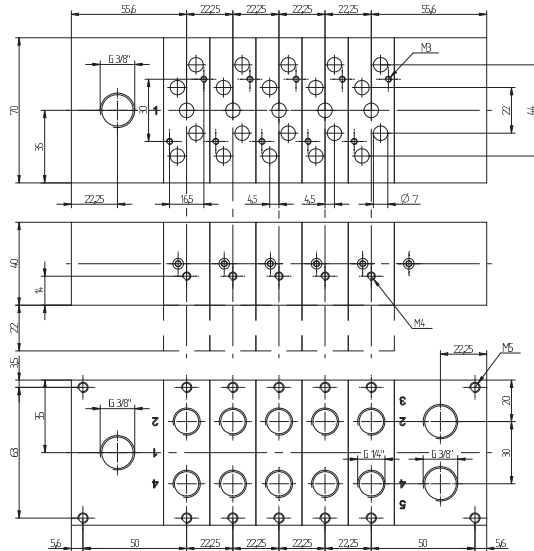

RB 5\_\_704 K1

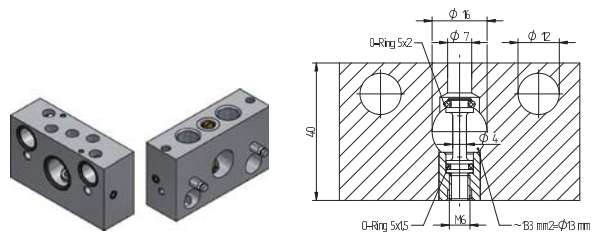

Individual valve isolation (R 5 704 K1 D1)

Type	Function	Weight
R 5 704 K1 R	End-plate right	0,13 kg
R 5 704 K1 L	End-plate left	0,12 kg
R 5 704 K1	Individual position	0,09 kg
R 5 704 K1 D1	Individual position, with individual valve isolation	0,09 kg