

RD 3__403/RD 3__464



Manifold plate type **RD 3__403**:
Common connection to port 1 (pressure) and 3 (exhaust).

The following valves can be assembled to the manifold:

- 3/2-way n.c. G 1/8" MD 310 403 page 2.5.1.2.3
- 3/2-way n.o. G 1/8" MOD 310 403 page 2.5.1.2.3
- 3/2-way n.c. pif 6 mm MD 310 463 page 2.5.1.2.3
- 3/2-way n.o. pif 6 mm MOD 310 463 page 2.5.1.2.3

Blanking plates are also available type BP 3 403.

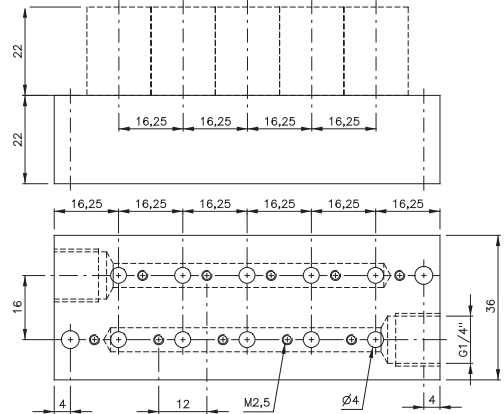

RD 3__403 Orifice size: 6 mm

Manifold plate type **RD 3__464**.
Common connection to port 1 (pressure) and 3 (exhaust).
The individual ports 2 are also in the manifold plate equipped with push-in fittings.

The following valves can be assembled to the manifold:

- 3/2-way n.c. MD 310 404 page 2.5.1.2.4
- 3/2-way n.o. MOD 310 404 page 2.5.1.2.4

Blanking plates are also available type BP 3 404.

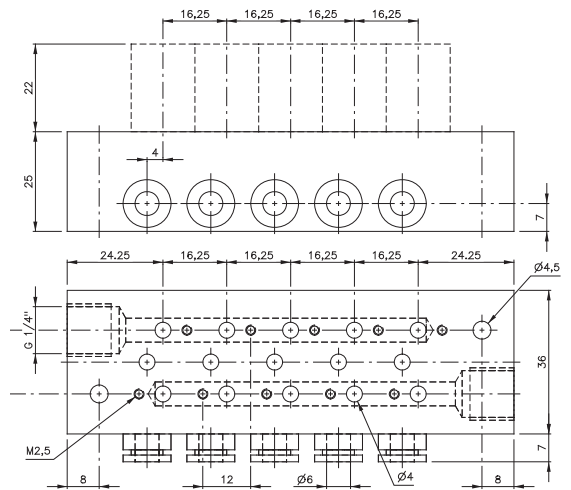

RD 3__464 Orifice size: 6 mm

Please note:
Due to the compact design of the plate if a larger number of valves are to switch at the same time please do not select plates with more than 6 stations.

Stations	Type	Weight	Type	Weight
2	RD 302 403	0,09 kg	RD 302 464	0,15 kg
3	RD 303 403	0,13 kg	RD 303 464	0,19 kg
4	RD 304 403	0,16 kg	RD 304 464	0,23 kg
5	RD 305 403	0,19 kg	RD 305 464	0,26 kg
6	RD 306 403	0,23 kg	RD 306 464	0,30 kg
7	RD 307 403	0,27 kg	RD 307 464	0,34 kg
8	RD 308 403	0,30 kg	RD 308 464	0,38 kg
9	RD 309 403	0,33 kg	RD 309 464	0,41 kg
10	RD 310 403	0,36 kg	RD 310 464	0,49 kg
12	RD 312 403	0,43 kg	RD 312 464	0,53 kg
14	RD 314 403	0,49 kg	RD 314 464	0,60 kg
16	RD 316 403	0,55 kg	RD 316 464	0,68 kg