

# SIMPG-5/1 /R 520 704 J

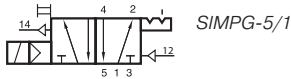

## SIMPG-5/1

5/2-way bistable valve with detent in both positions.

Electric signal at 14 actuates the valve, the spool locks. If the electric signal is taken away, the valve stays in this position.

A pneumatic signal has to be applied to port 12 to change the position again.

Pilot port 14 is not an external pilot feed but an additional signal can be taken, when solenoid is actuated.

Valves can be used with industryform B coils (22 mm) type MA 22 displayed on page 2. 14.2 as well as Form A coils (30 mm) type MA 30 S9 displayed on page 2. 14.4.

Available with solenoid operators:  
230V/50Hz, 110V/50Hz, 48V/50Hz, 24V/50 Hz, 24V=, 12V=.

Valve is generally equipped with manual override.

Mounting screws and seals are included.

Pneumatically actuated versions available on request.

## R 520 704 J

Single base-plate for valves type MH 5\_ 704 J and SIMPG-5/1.

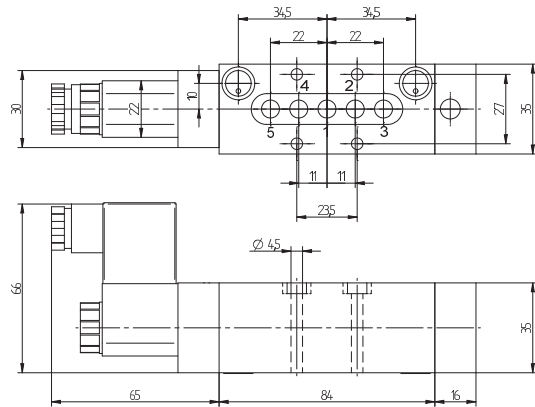

SIMPG-5/1

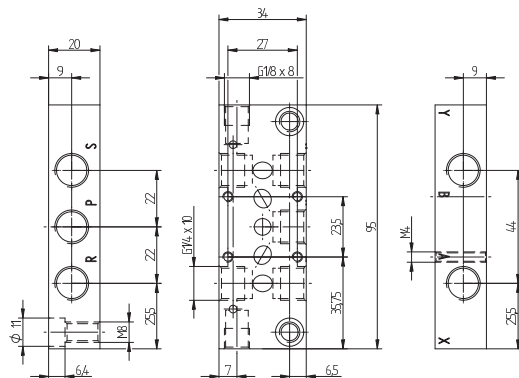

R 520 704 J

Type	Port size	Air flow	Operating press.	Power consumption	Weight
SIMPG-5/1	Ø 7 mm	1250 l/min	2 - 10 bar	3 W = / 5 VA ~	0,34 kg
R 520 704 J	G 1/4"	1250 l/min			0,20 kg